

MATERIAL AND LOAD INFORMATION:

BEARING MATERIALS  
TIMBER C18/C24  
LVL GL30c  
STEEL S235/S355  
LVL KERTO-S

LOADS (EUROCODE)  
SNOWLOAD ON GROUND  $q_k=0,7 \text{ kN/m}^2$   
ROOFING (TILES)  $g_k=0,6$   
ROOF  $g_k=0,3$   
WIND LOAD:  $q_k=0,6$   
INTERMEDIATE FLOORS  $q_k=2,0$   $g_k=1,0$

OUTER WALL FRAME  
VERTICAL FRAME 44x173 c600  
BEAMS 45x198, C24

ROOF TRUSSES FACTORY  
PRODUCED NAIL PLATE  
SUPPORTERS c900

USED DESIGN NORM: :  
- EUROCODE  
- CLASS OF SANCTIONS CC2  
- FIRE CLASS P3

DESIGN LIFETIME (SFS-EN 1990):

- Residential building + 60y
- Exceptions are interchangeable parts of structures 10.25y (weather prone terrace structures)
- Terrace bearing wooden structures (PK): PROTECTION CLASS A

ROOF TRUSS AND INTERMEDIATE FLOOR JOIST FASTENING AND SUPPORT:  
RING BEAMS, CORNER BRACKET 60x60/90 c1200 NAILS 4,0x40 3  
INTERMEDIATE FLOOR +3PCS JOIST NAILING TO RINGBEAM 3,1x90 4+4 PCS  
JOISTS, ROOF TRUSSES, AND DIVIDING WALLS 3,1x90 4 PCS  
WIND BRACES, ANGLE BRACKET TO OUTERWALLS 60x60/90x2,0  
NAILS 4,0x40 3+3PCS  
BOARD 25x100 (NAILS 2,8x75 3PCS)

STRENGTHENING STRUCTURES OF BUILD:

OUTER WALLS, PLASTERBOARD 9mm  
FASTENERS KG 745 ctk c70  
U2-3 and U2-5 FULL PLATE  
SCREWS c75/c150

DIVIDING WALLS, PLASTERBOARD EXTRA HARD  
13mm, SCREWS 3,8x32 c150 AT  
EDGES, c300 IN MIDDLE

ROOF, CROSS BOARDS 25x100  
NAILS 2,8x75 4 PCS/seam  
OSB or CHIPBOARD 22mm

INTERMEDIATE FLOOR,  
SCREWS IE. 5x50 c200  
(or Ringshank nails 2,8x60 c150)  
+ POLYURETHANE GLUE

U1-ELEMENT FASTENING:  
L-FASTENER 3,0x40x50/160 c1200  
ELEMENT SCREWS 5x60 2PCS  
FOUNDATION NAILS:  
FNH 6/60 2pcs (CONCRETE),  
LG 6/50 2pcs (LIGHT CONCRETE),  
WURTH W-RD 6/60 2pcs (BRICK)

DIVIDING WALLS: FNH 8/110 c600 (CONCRETE)  
FAÇADE PLUG 8/100 k600 (LIGHT CONCRETE)

WALLS BETWEEN APARTMENTS:  
BMF-7048 (L 90x48x3,0x48) c1200 NAILS 2N 3,4x100,  
LG 6x50, 2pcs (LIGHT CONCRETE)

1. CORNER BRACKET 60x60/90 MP.  
NAILS 4,0x40, 3+3 PCS

2. CORNER BRACKET 60x60/90  
NAILS TO LOWER END 4,0x40, 3 PCS  
NAILS 6/60 TO FOUNDATION 2 PCS

NAILING OF POSI-INTERMEDIATE FLOOR JOISTS TO  
RINGBEAM 3,1x90 4+4 PCS  
MID-SUPPORT 4N, 3,1x90

When installing Posi-joists the installation of HVAC pipes must  
be noted before final installation of the joists.

Support beam 48x198 is nailed to vertical posts with 3x3,1x90  
nails

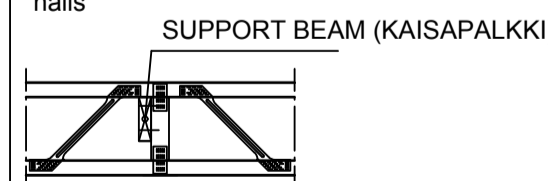

LVL WOOD:  
KP 45x260 L10770, 2pcs

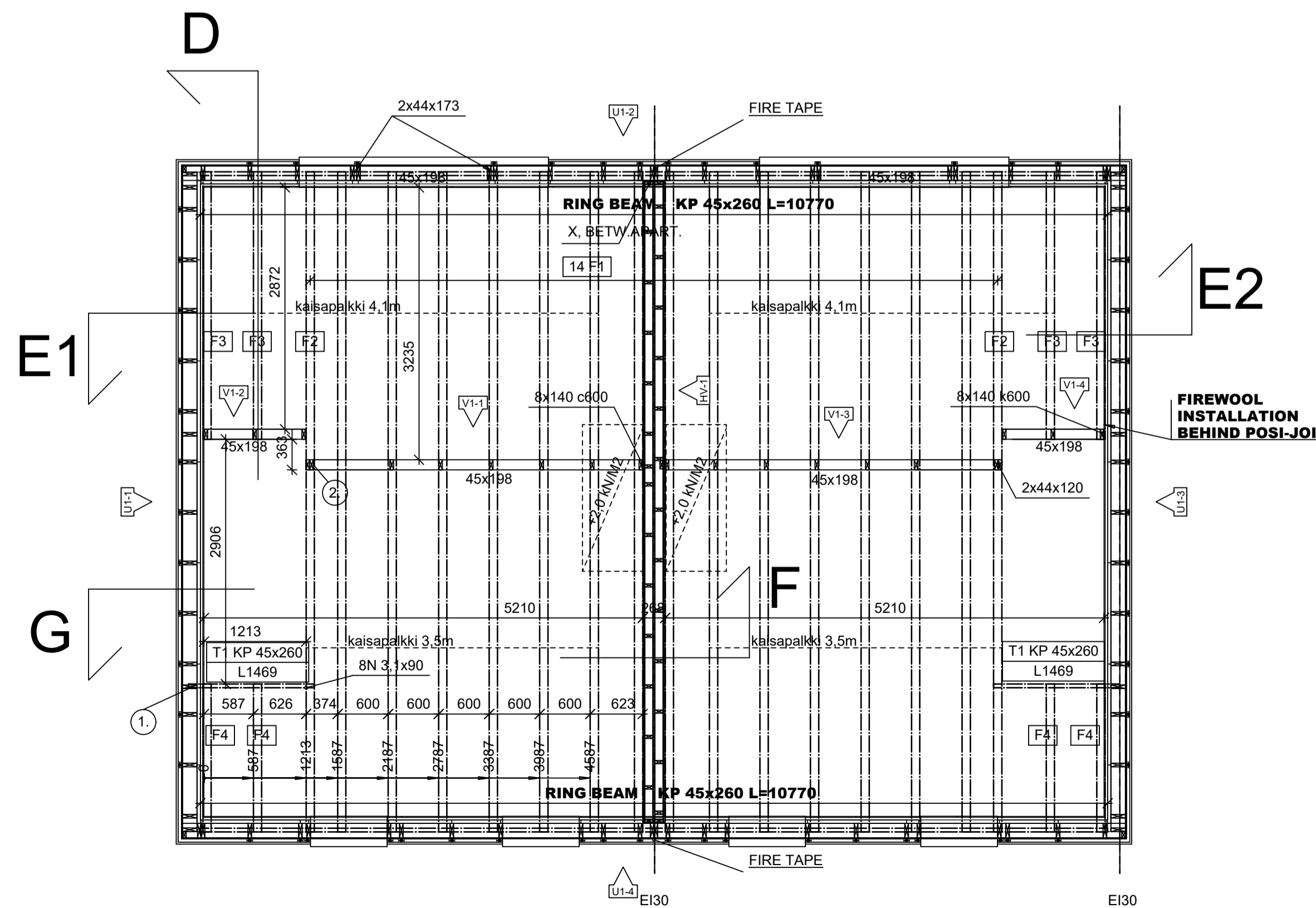

Project	STRATA HOMES LTD	Drawing number	TE-6880-PD-007 Rev 01
Location	Dunstonroad S41 8NL	Drawing type	Principal drawing
Client	Chesterfield	Project name	TALO ELEMENTS
Designer	Jari Rissanen DI	Drawing name	WOODEN STRUCTURAL DRAWING J-6880
Date	20.7.2020	Scale	1:50
Check	Jari Rissanen DI	Work nr	RAK 6880